

SL EVOLVE IN-WALL RECESS BOX

The Evolve In-Wall Recess Box, will elegantly enable the Evolve speaker models, 3-1 to 8-4 to be mounted flushed, in a standard stud wall.

The Evolve In-Wall Recess Box is available in a basic primer, or the Artcoustic high-end paint quality, any colour.

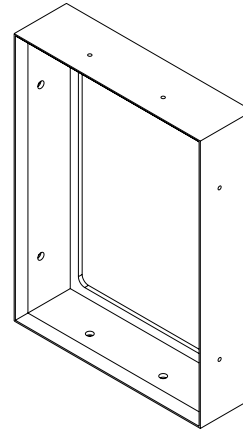

SCHEMATICS

dimensions are in mm

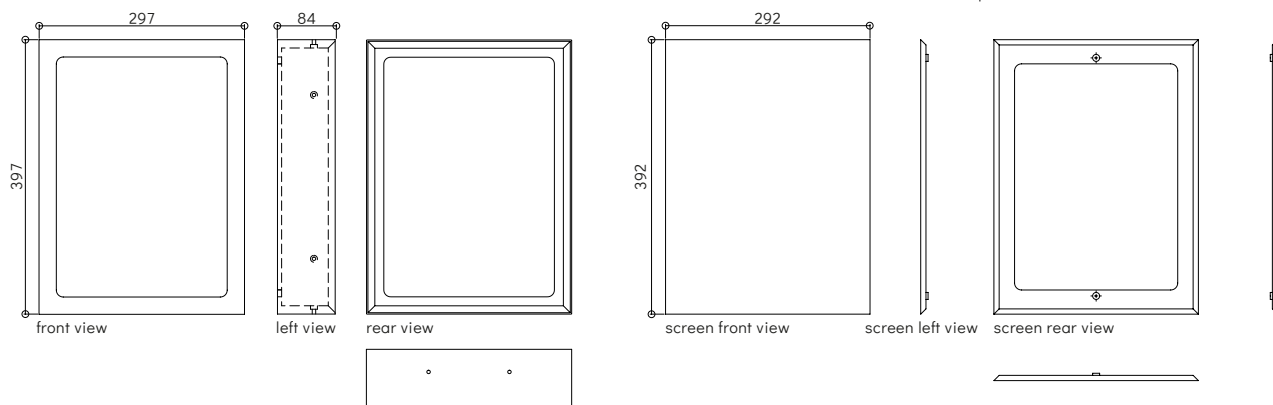

INSTALLATION

- Cut out hole, according to the recess box dimensions.
- Mount the recess box in the cut-out.
- Secure the recess box to stud wall, with suitable screws.
- Mount the speaker in the recess box.
- Mount the speaker screen, with magnet fittings.
- Your speaker is installed.