

# Artcoustic<sup>ACC</sup>

## CPH-10A STEREO

Owners manual

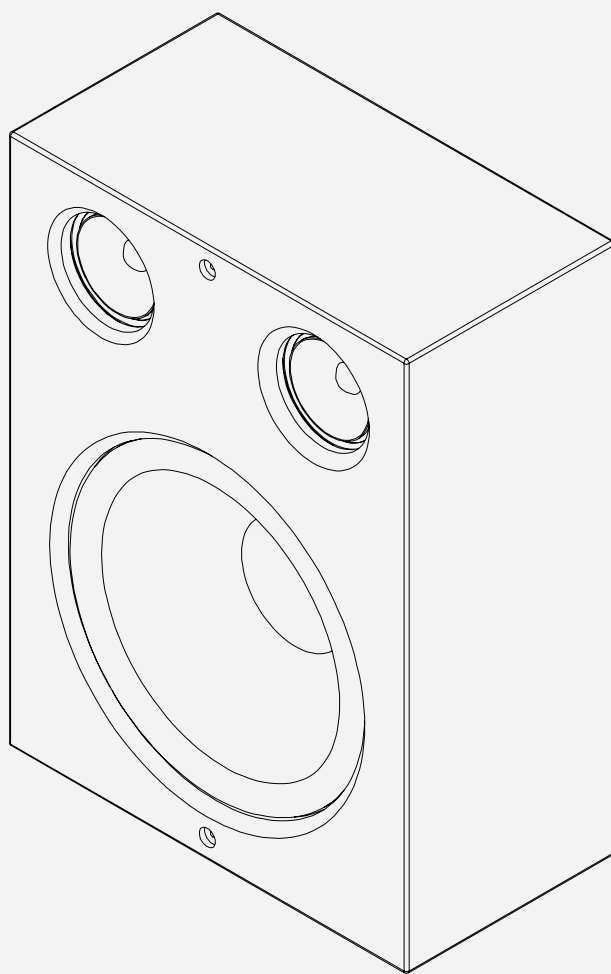

# WELCOME TO THE WORLD OF ARTCOUSTIC

Congratulations on your purchase of the Artcoustic CPH-10A Stereo active monitor.

The CPH-10A Stereo (Active) combines the latest Bluetooth technologie selectronic EQ and filters, with raw power and exceptional, sound pressure level. It has been designed to ensure the utmost functionality, making it easy to install, either when wall-mounted or free-standing.

The slim-line profile, combined with powerful and articulated performance, makes the CPH-10A an ideal choice for high-end Hi-Fi and multi room audio installations, without the need for a subwoofer.

The design has been refined to the bare minimum, removing all unnecessary elements, all in keeping with the Artcoustic signature style. Match your speaker to your interior by choosing from an unlimited selection of cabinet and screen colours or you own choice of artwork.

The CPH-10A Stereo provides high-end sound reproduction whether from a single speaker stereo mode, two speakers in a dual mono setup, or multiple speakers for multi room audio, delivering a clean and detailed sound experience, whatever the application.

Thank you for purchasing this Artcoustic CPH-10A Stereo product.

All the best,  
The Artcoustic Team

# WHAT'S IN THE BOX

1 PCS ARTCOUSTIC CPH-10A STEREO ACTIVE LOUDSPEAKER

1 PCS DC 21V, 5A DC MULTI-VOLTAGE POWER SUPPLY

1 PCS POWER CORD

1 PCS IR REMOTE

1 PCS IR RECEIVER

1 PCS A4 SIZE USERS MANUAL



## REMOTE CONTROL FEATURES

1. On/Off
2. Play and pause, BT two-way function
3. Amplifier mute
4. Volume p and Volume Down
5. Next and Previous track, BT two-way function
6. AUX 2
7. BT input
8. Coaxial input
9. Optical input
10. AUX 1

\*BT : Bluetooth

\*AUX : Auxiliary

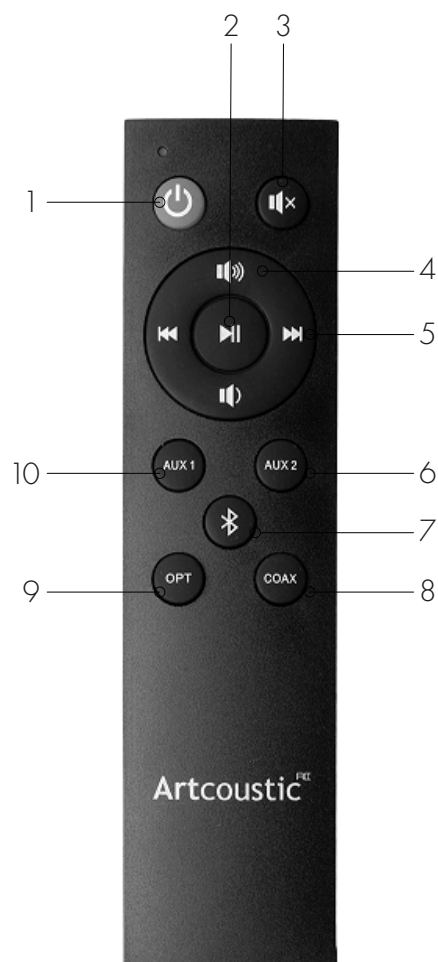

# FEATURES

## CPH-10A STEREO MONITOR

### INCREDIBLE BASS RESPONSE

The CPH-10A is a true 2.1 speaker system, powered by three individual amplifiers and carefully separated by a state-of-the-art active crossover and hi-fi quality signal processing.

The CPH-10A Stereo monitor, is equipped with a single 10-inch, subwoofer and two high-end 3 inch full range units.

The CPH-10A Stereo delivers a bass response extending well down to 40 Hz, resulting in a low frequency performance equivalent to a speaker twice its size.

### SPARKLING HIGH-FREQUENCY PERFORMANCE

The CPH-10A Stereo also excels at the upper end of the frequency spectrum, with a frequency response of up to 20 kHz at 92 dB (1W +/-2 dB).

Overall the performance is exemplary with good, tight bass and sparkling high frequency performance, all within the Artcoustic's Scandinavian design aesthetics.

### IDEAL FOR ANY INTERIOR

The CPH-10A is ideal for 1 & 2 channel listening, small to medium sized home cinema installations, commercial use in bars, restaurants and corporate facilities.

### DESIGN CUSTOMISATION

Choose from unlimited colour options from NSC, RAL, and almost all well-known paint companies to match your cabinet colour and screen to your interior.

Artcoustic has created a true all-rounder, covering most medium SPL applications, where high performance and aesthetics is a focal point.

### HIGH QUALITY MULTI-CHANNEL AMPLIFICATION

The CPH-10A Stereo active monitor, has been designed with high quality class D 3-channel amplifiers delivering remarkable low distortion power.

### LONG LASTING POWER

The CPH-10A Stereo is powered with a high performance 21V external switching power supply, but can equally be powered by any 12-21V battery power bank.

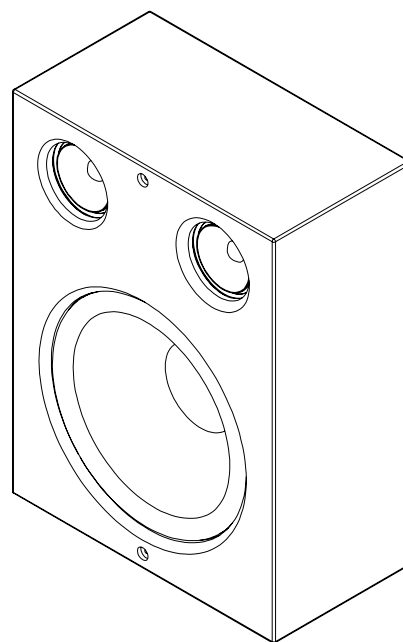

isometric front view

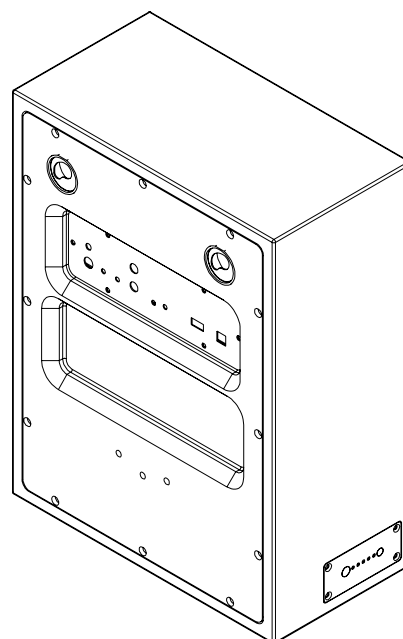

isometric rear view

# FEATURES

## COMPONENTS OVERVIEW

### CONNECT TO ALL YOUR DEVICES

The CPH-10A Stereo can be used as a single unit in either wireless Bluetooth mode, or as RCA wired connection. The CPH-10A Stereo can also be used in a stereo or multiple speaker setup, through the RCA wired input, for multiple speakers used in a wireless setup.

For multi-room audio, connect with the Artcoustic X10 RF wireless system.

The CPH-10A Stereo has a 5V USB charger output reserved for powering devices, such as the Artcoustic X10 device, Audiocast Wi-Fi device etc. but this can also be utilized as a mobile phone and tablet charger.

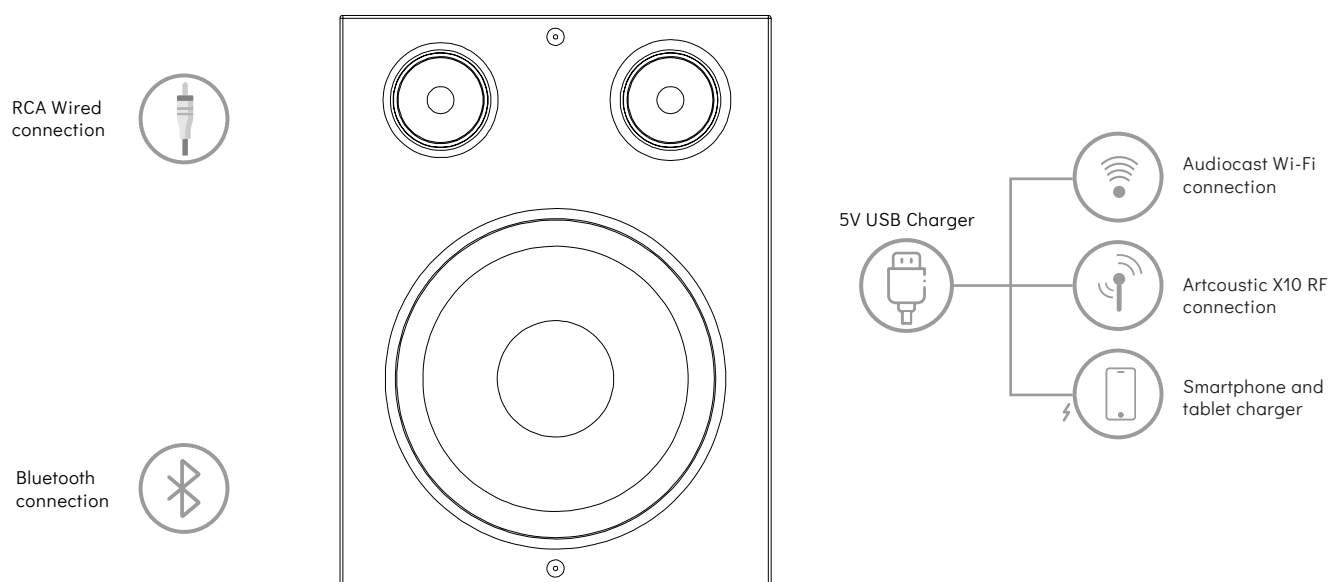

### CROSSOVER

100 Hz 24 dB/octave Low Pass Filter  
120 Hz 24 dB/octave High Pass Filter.

### AMPLIFIER

High-end 50 watt class D subwoofer amp. and 2 x 30 Watt Class D mid and high frequency amp. RCA stereo input Mini Jack stereo input Optical digital input Coaxial digital input Bluetooth wireless connection

### SUBWOOFER

Extra long excursion and aluminium Short Circuiting Ring, 4-layer voice coil, anodised aluminium for improved heat dissipation, combined with Distortion Reduced Motor.

### MID-HIGH FREQUENCY DRIVER

Our full range driver includes a stiff steel basket with venting under the spider to aid cooling of the motor, a ferrite magnet motor with copper cap to lower coil inductance, providing low distortion at low frequencies and extended high frequency response.

A black anodized aluminum cone is employed along with a black anodized aluminum dust cap coupled directly to the voice coil. Additionally, the cones come equipped with special-designed large roll rubber surrounds, which allow for a dynamic linear response at high excursion.

# SPECIFICATIONS

## CPH-10A STEREO MONITOR

### TRANSDUCER

LF-MF 1 x 10 inch cone  
HF-MF 2 x 3 inch cones

### CROSSOVER

Low Pass Filter 6 dB/octave 1000 Hz  
High Pass Filter 12 dB/octave 4000 Hz

### CONNECTION

Single Amped Gold Plated Push Terminals

### PERFORMANCE

Operating Range 40 Hz (-3dB) to 20 kHz  
Calculated Axial Output Limit (Half Space SPL) Average Peak LF/MF-HF 106dB  
Maximum Power Handling 1x50 Watt and 2x30 Watt  
Input Impedance Nominal Minimum 8 ohms  
Nominal Beamwidth Horizontal 80° Vertical 90°

Recommended High Pass Filter 100 Hz, 24 dB/octave

### DESIGN

Cabinet: Black, White, RAL, NCS, Tikkurila  
Screen: Black, White, RAL, Tikkurila, Artcoustic Art Gallery

#### OPERATING RANGE

40 Hz — 20 kHz  
-3dB 40 Hz

#### MAX SPL



106 dB

#### MAXIMUM POWER



1x50 Watt  
2x30 Watt

Input Impedance  
Nominal 8 ohms

#### NOMINAL BEAM WIDTH



Horizontal 80°  
Vertical 90°

#### DIMENSIONS



H: 400 W: 300 D: 158 mm

#### WEIGHT



8.6 kg

# OVERVIEW

1. Input Selection and ON/OFF
2. LED Input Indicator
  - AUX1
  - AUX2
  - OPTICAL
  - COAXIAL
  - BLUETOOTH
3. IR Receiver
4. Coaxial Digital Input
5. IR Remote Input (Wired Remote Receiver)
6. AUX2 Stereo Input
7. AUX1 Stereo Input
8. Stereo Link Out
9. Subwoofer Link Out
10. 5V USB Charger
11. 12-21 DC Power Input
12. Optical Digital Input

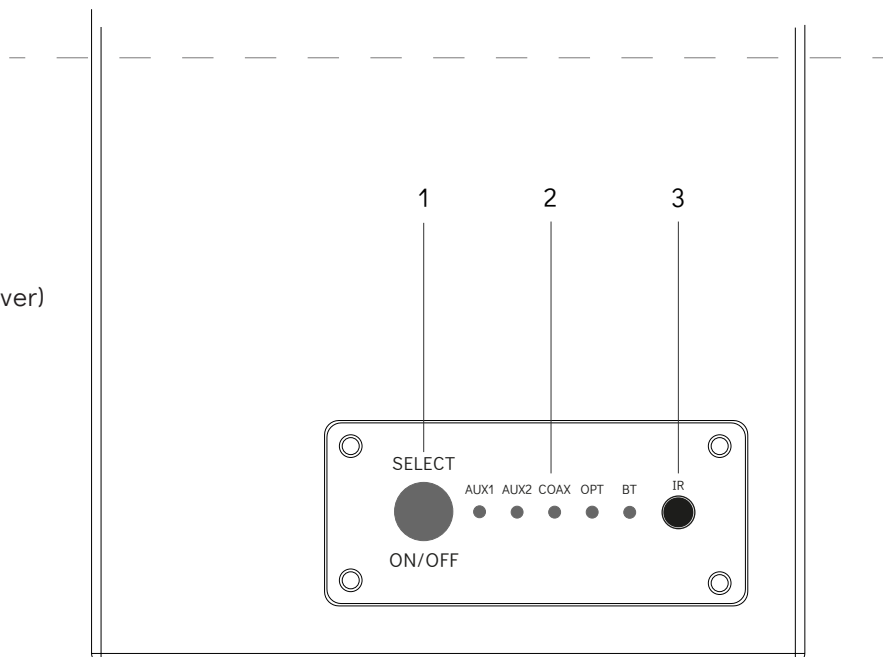

left view

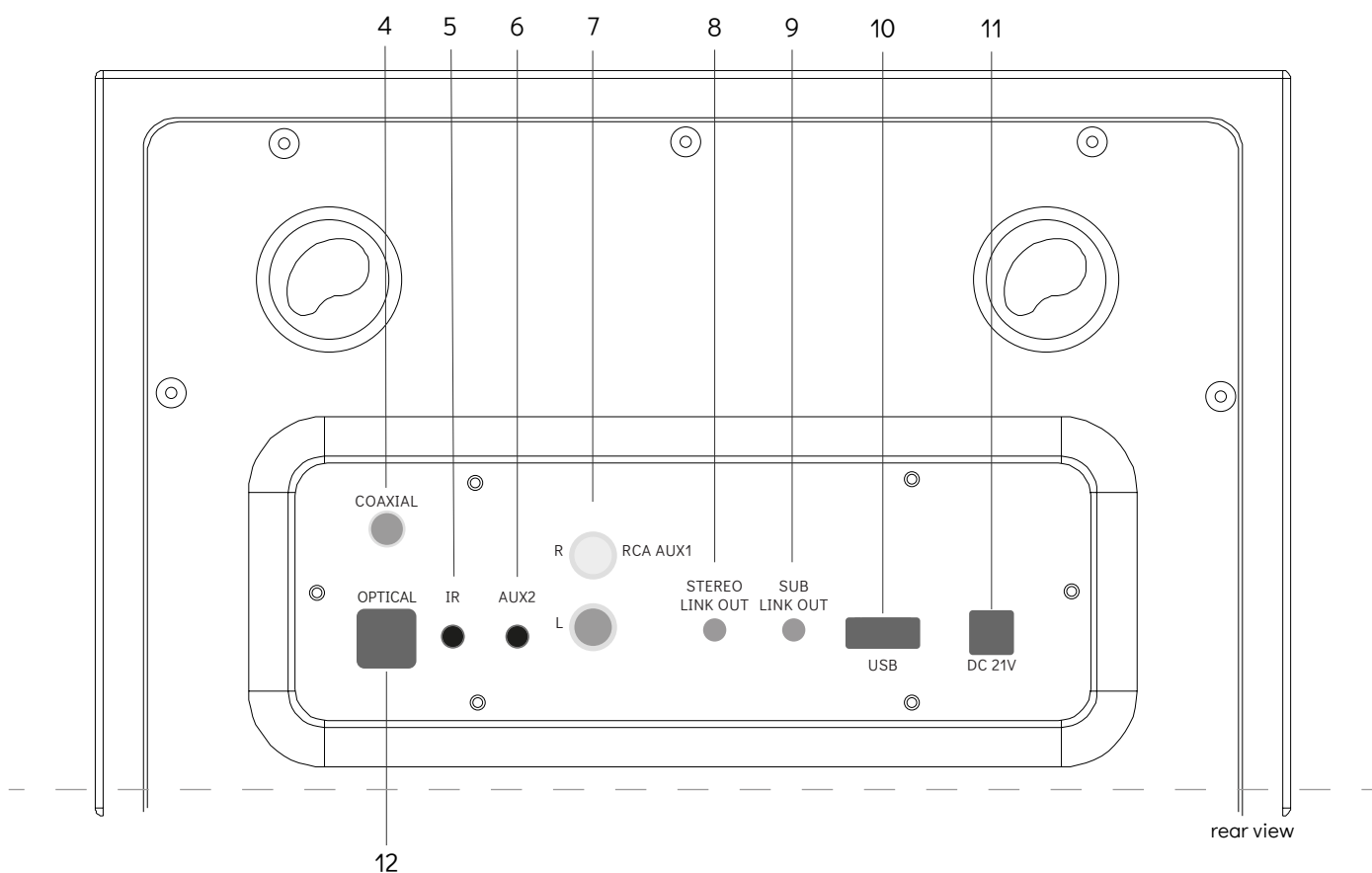

rear view

# SCHEMATICS

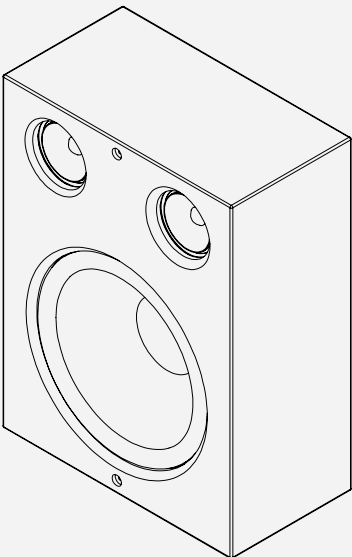
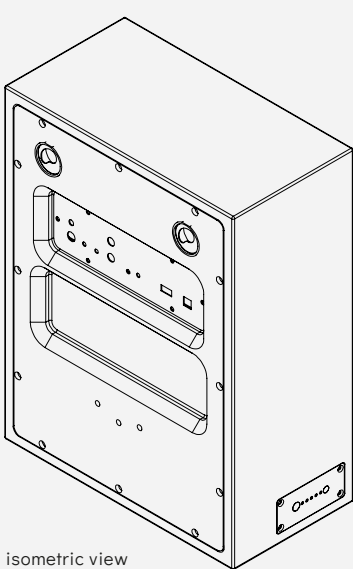

top view

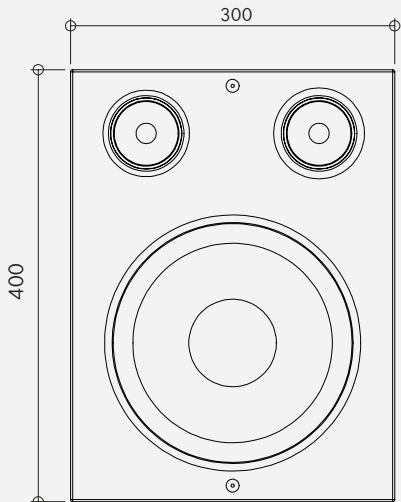
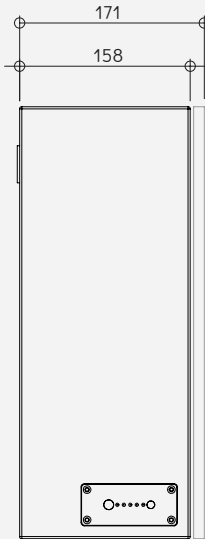
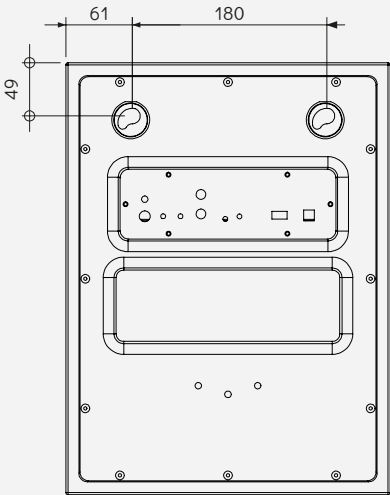



# SCHEMATICS

CPH-10A Stereo wall mounted utilizing the Artcoustic GU8-T bracket.

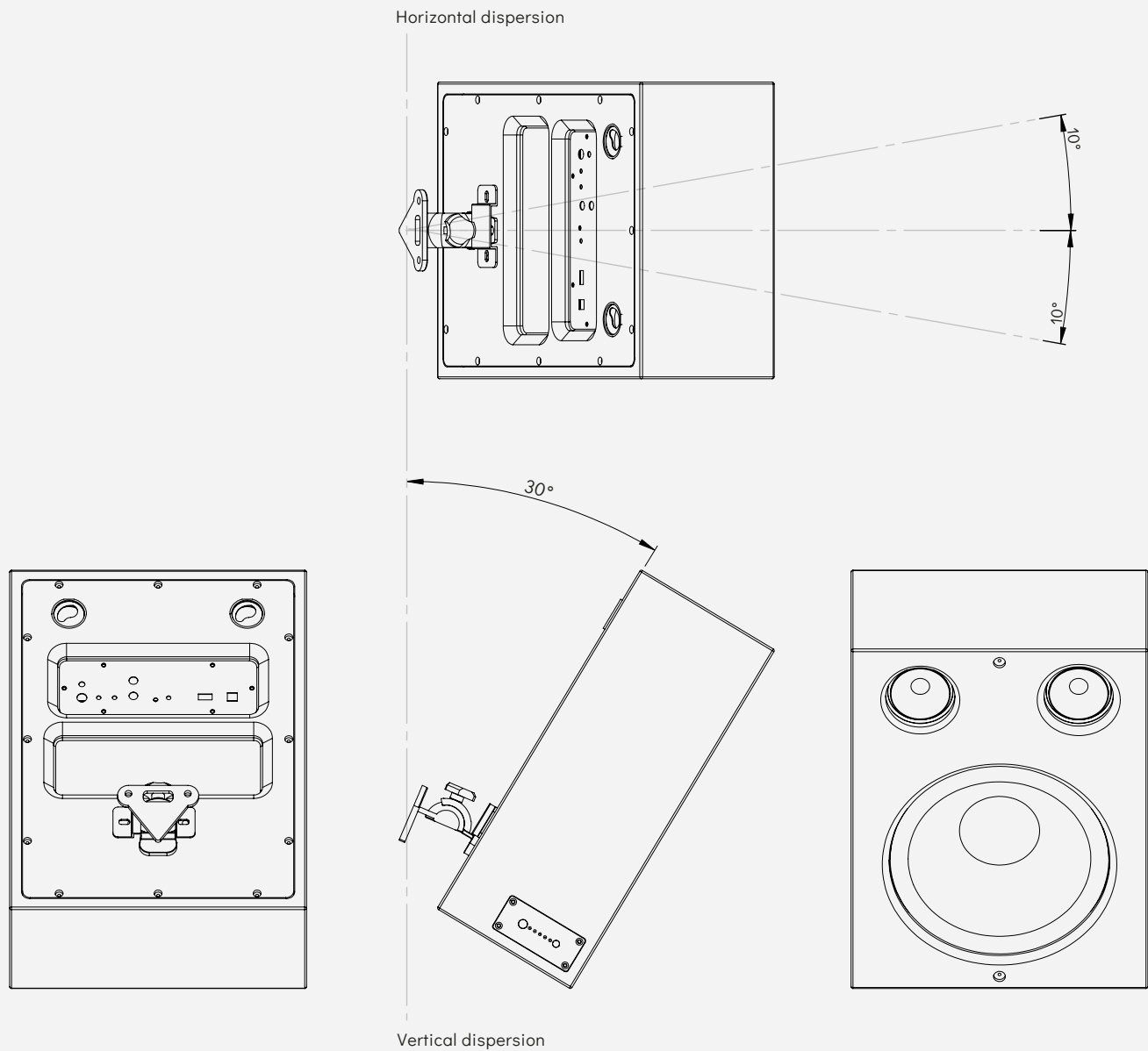

# CONNECTIVITY

## CONNECTING WITH BLUETOOTH

Fast and easy wireless connection for virtually any device.

1. Enable Bluetooth pairing on your CPH unit.

The Red BT LED indicator will flash with fast intervals, giving the user a 2 minute pairing time. If no BT source has been paired within 2 minutes, the BT port will close again and pairing process will have to be repeated.

2. Enable Bluetooth pairing on your CPH device and select CPH as your Bluetooth receiver.

3. Adjust the volume on the CPH-Trio and on your mobile phone, tablet or other Bluetooth device.

Note: Unpairing of the Artcoustic CPH unit can be done from the paired device, or by power off.

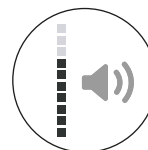
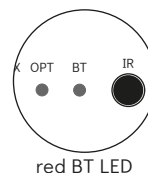

## CONNECTING WITH ANALOG WIRES

On the rear panel of CPH Unit, the RCA and mini jack L & R input will support an analog signal, connect both the L & R channels in order to achieve Stereo output.

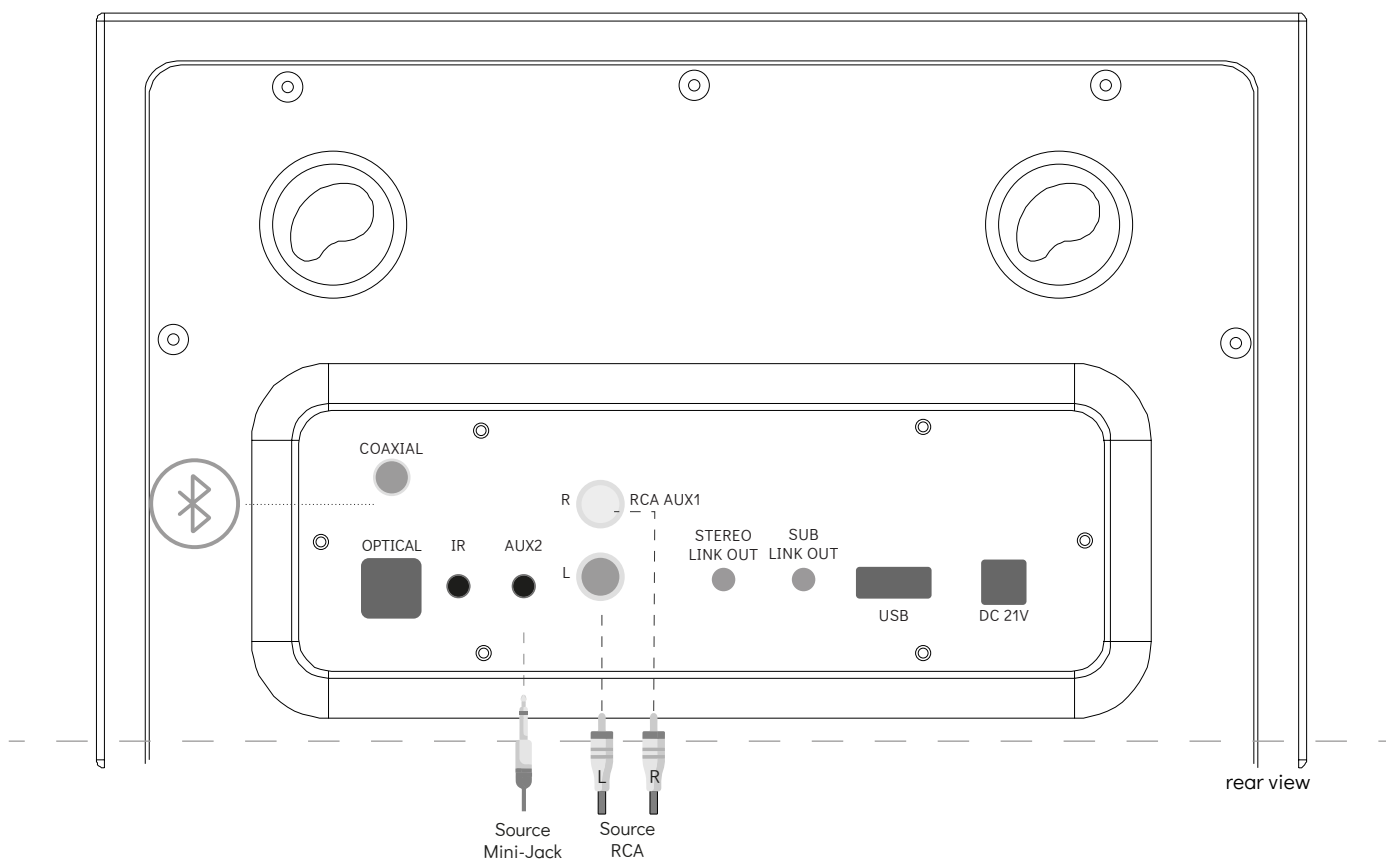

# CONNECTIVITY

## CONNECTING WITH WIFI

There are many high quality Wi-Fi solutions available. The below setup is using the AudioCast dongle, but should serve as one example only.

CONNECTING A SINGLE SPEAKER USING AUDIOCAST DONGLE, OR SIMILAR WIRELESS DEVICE.

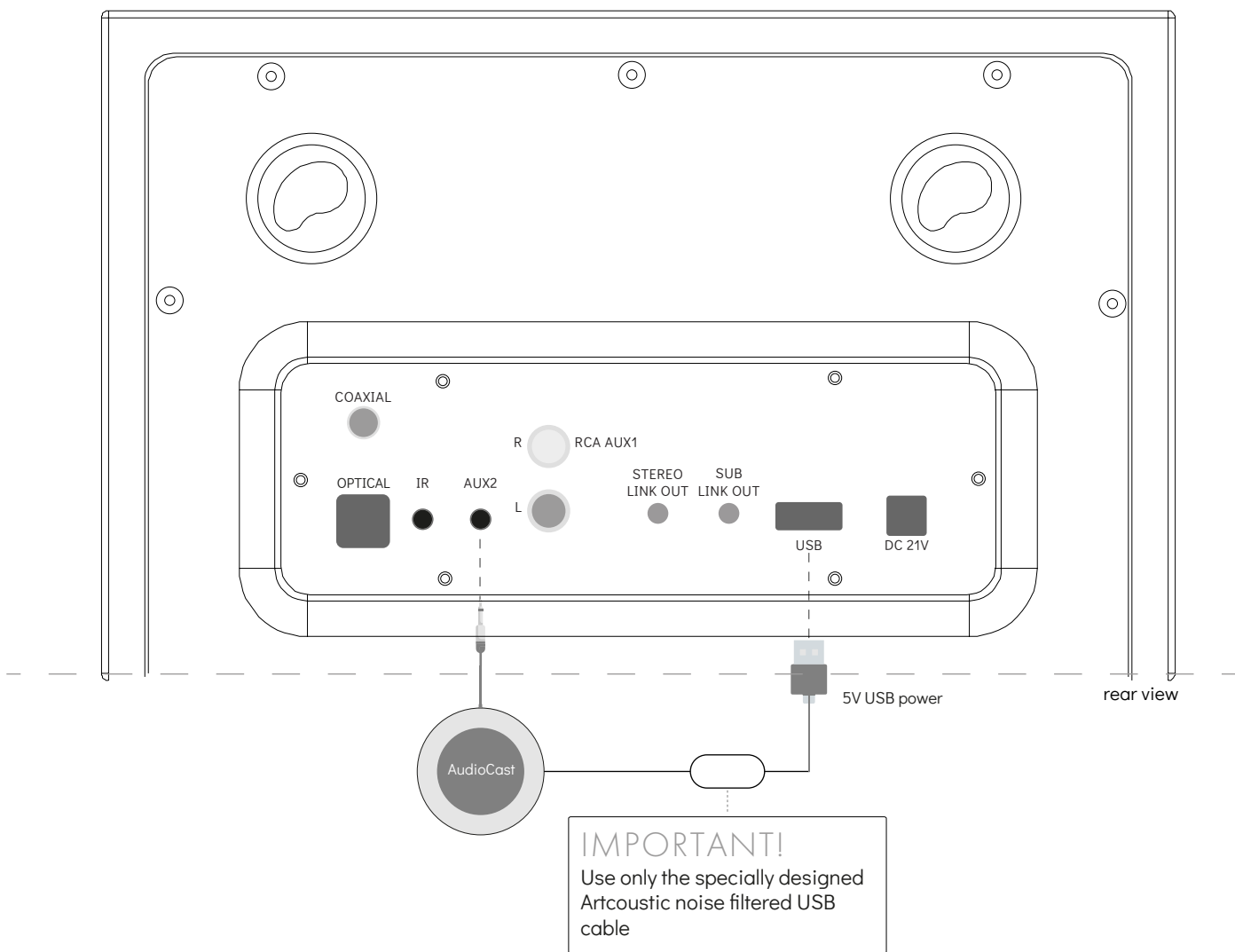

# CONNECTIVITY

## CONNECTING WITH WIFI

CONNECTING TWO OR MORE SPEAKERS IN STEREO USING AUDIOCAST DONGLE, OR SIMILAR WIRELESS DEVICE.

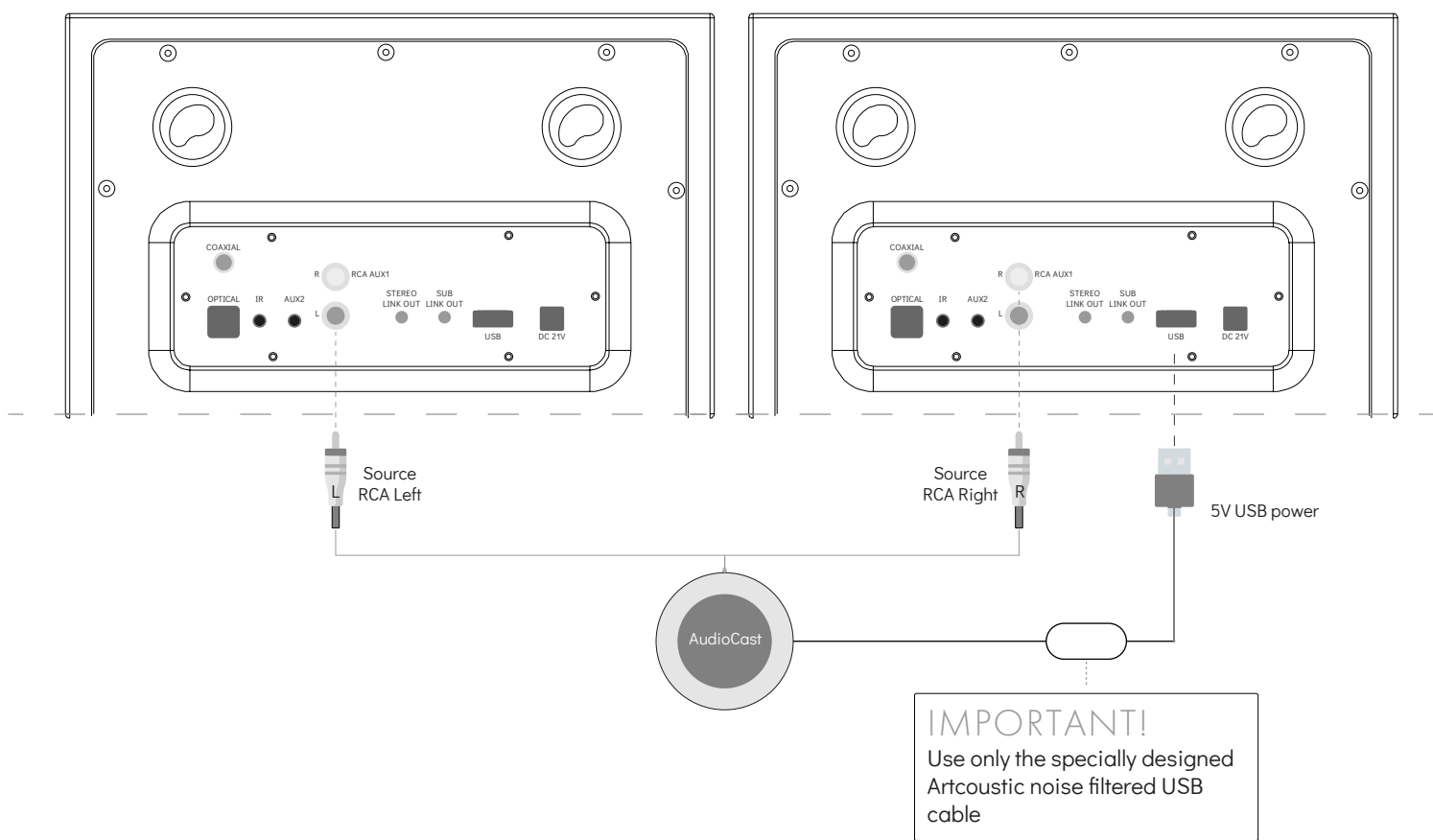

# CONNECTIVITY

## CONNECTING WITH ARTCOUSTIC X10 RF MULTI-ROOM AUDIO SYSTEM

Artcoustic X10 RF Multi-Room Audio System.  
Connect up to 10 zones in perfect sync.  
No app required and no network required.  
The ArtcousticX10 Multi-Room Audio System streams any analogue source in close to loss-less audio quality and with a streaming reach up to 100 meters.

### CONNECTING A SINGLE SPEAKER USING ARTCOUSTIC X10 RF RECEIVER.

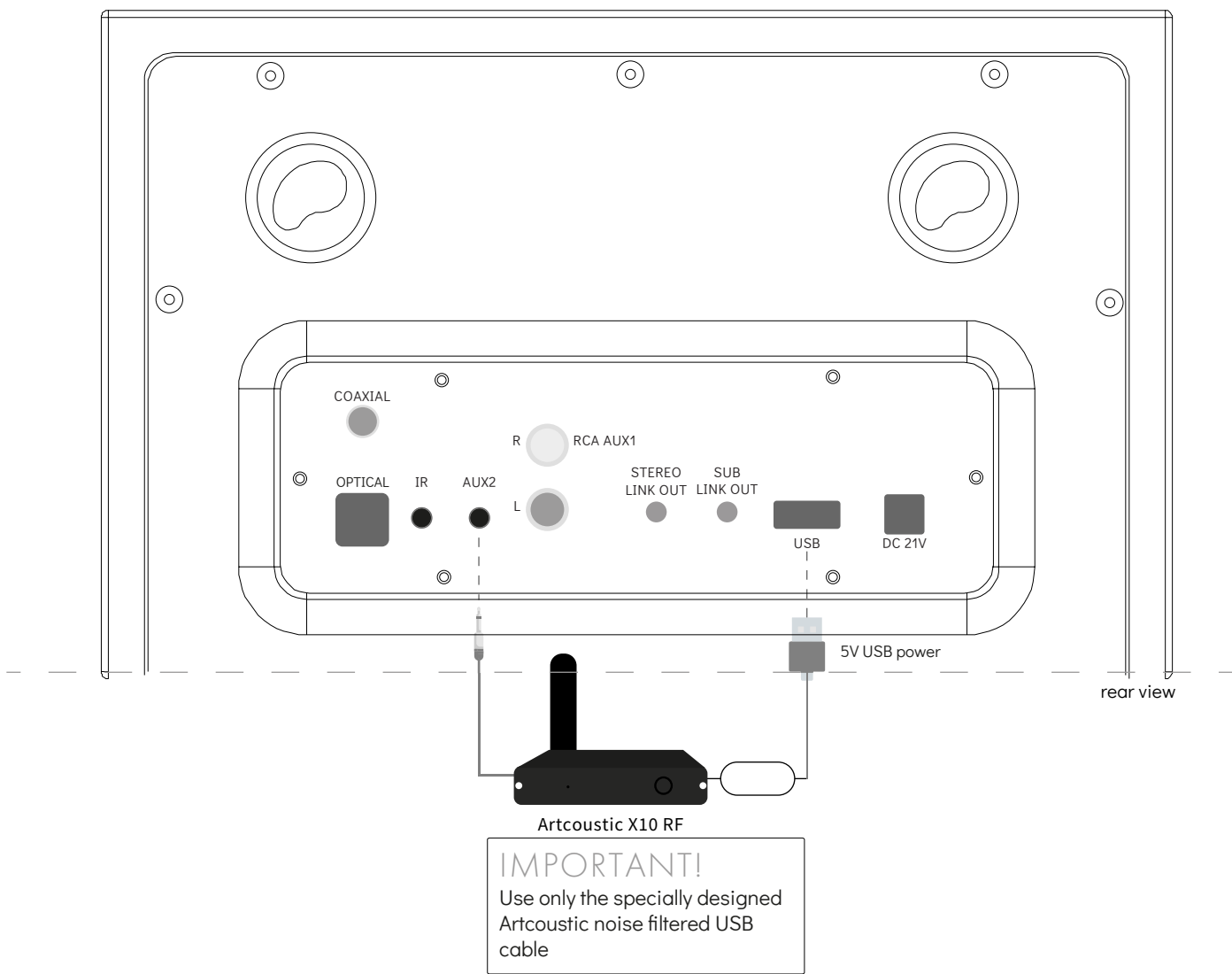

# CONNECTIVITY

## CONNECTING TO DIGITAL DEVICES

On the rear panel of CPH unit, the digital coaxial and optical input will support a digital signal, from devices such as smart LED TVs, digital receivers and DVD players

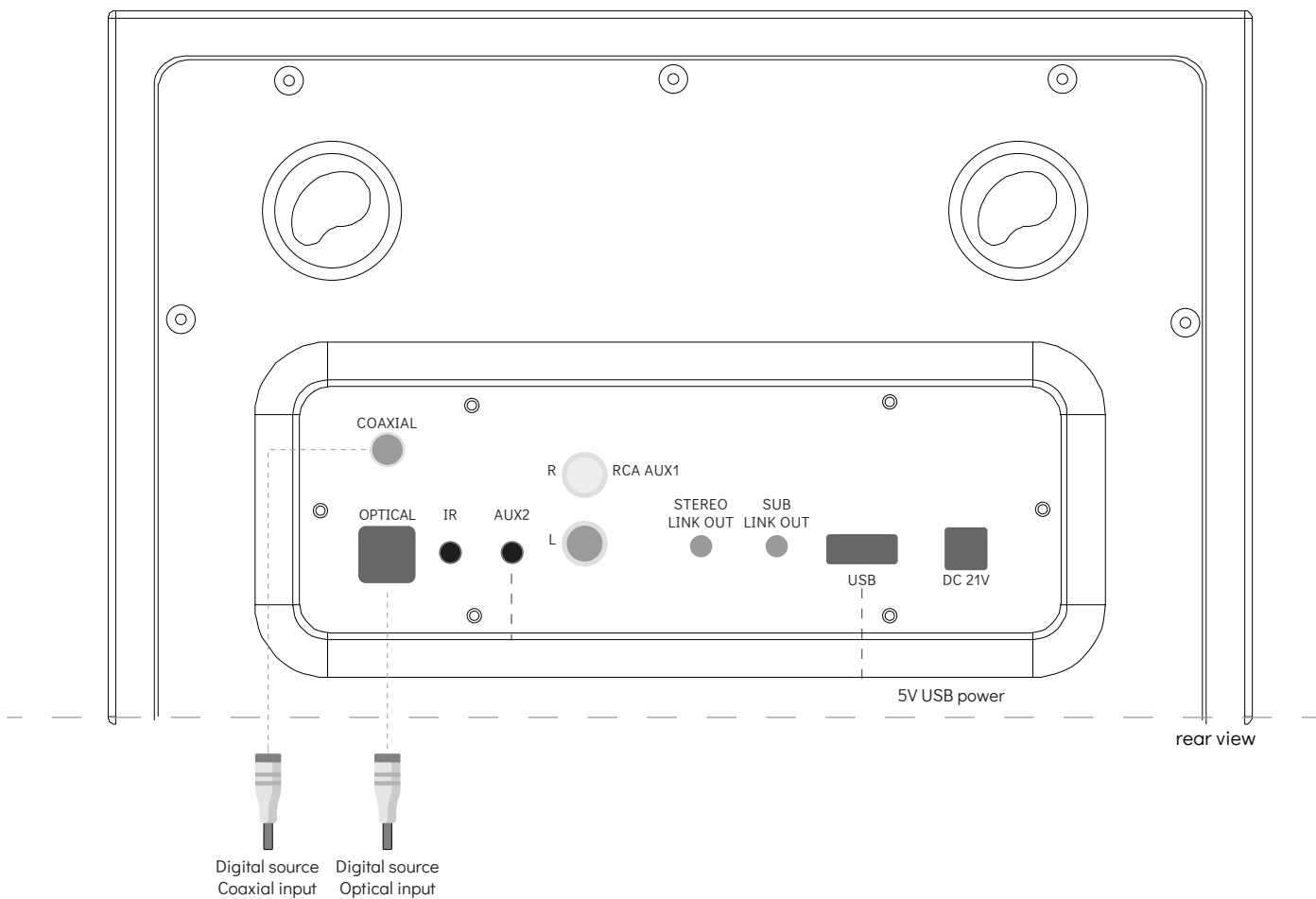

# SAFETY INSTRUCTIONS

## SAFETY



Do not use this product near water



Clean rear panel with dry cloth only



Do not block any ventilation opening



Do not install near any heat sources



If wall-mounted, ensure the use of matching screws and rawl plugs

## WARNING

This product complies with Part 15 of the FCC Rules. Its operation is subject to the following two conditions:

- This product may not cause harmful interference.
- This product must accept any interference received, including interference that may cause undesired operation.

Changes or modifications not expressly approved by the party responsible for compliance could void the user's authority to operate the equipment.

To reduce the risk of fire and electric shock do not expose this product to rain or moisture.



Do not place product filled with liquids such as vases on the product.



Do not open product. There are no user-serviceable parts inside.



Always use the power supply shipped with this product. Using a power supply with wrong voltage or polarity, can damage the electronics.



# WARRANTY

## IS APPLICABLE



Is valid only for products purchased from an authorised Artcoustic retailer or dealer.



Is valid from the date of purchase for a period of 3-years for passive loudspeakers, and 2-years for powered loudspeakers and electronics.



Is limited to the repair of the equipment (which could be a repair or replacement at our discretion, neither of which affects your original warranty).



Neither transportation, nor any other costs, nor any risk for removal, transportation and installation of products is covered by this warranty.

## IS NOT APPLICABLE

Will not be applicable in cases other than defects in materials and/or workmanship at the time of purchase and will not be applicable:

- For deterioration of component parts, the nature of which is to become worn or depleted with use, such as batteries.
- For damages caused by incorrect installation, connection or packing.
- For damages caused by accidents, lightning, water, fire heat, war, public disturbances or any other cause beyond the reasonable control of Artcoustic and its appointed distributors.
- For damages caused by any use other than correct use described in the user manual, negligence, modifications, or use of parts that are not made or authorized by Artcoustic

If it is found necessary to return the product for repair, you will be given a form to fill out and return. You should not return the product without previous acceptance. To validate your warranty, you will need to produce the original sales invoice or other proof of ownership and date of purchase.